

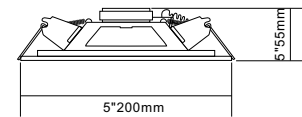

# Ceiling Speaker (With Tweeter)

## T-105A

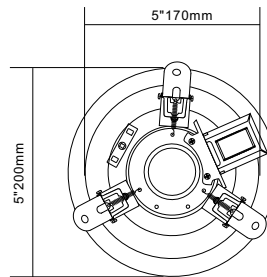
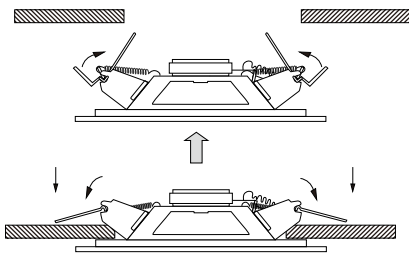
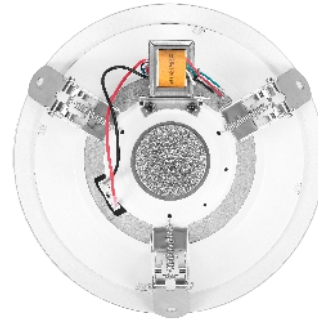

<b>Model</b>	T-105A
<b>Power Taps @100V</b>	1.5W, 3W, 6W
<b>Power Taps @70V</b>	0.75W, 1.5W, 3W
<b>Impedance</b>	Black: Com Red: 6.7 K $\Omega$ Green:3.3K $\Omega$ White:1.7K $\Omega$
<b>SPL(1W/1M)</b>	94dB
<b>Max. SPL (Rated W/1M)</b>	102dB
<b>Frequency Response (-10dB)</b>	110-18KHz
<b>Finish</b>	Baffle: Steel, White Grille: Aluminum, White
<b>Speaker Driver</b>	5" x 1 1.5" x 1
<b>Cutout Size</b>	170mm
<b>Dimensions</b>	200 x 55mm
<b>Weight</b>	0.8Kg
<b>Mounting</b>	Spring-clip